

# Grinding and inspection vices

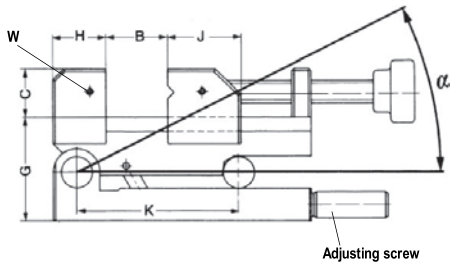

A29  
PS-SV, front swivelling axis

Item no.	Size	Squareness / 100 mm	Parallelism / 100 mm	Angular accuracy	Jaw width mm	B mm	Total height mm	C mm	Length body mm	G mm	H mm	J mm	K mm	$\alpha$	W	Weight kg
370778	1	0,005	0,002	bei 45° ± 15°	70	80	93	30	160	63	33	45	100	0° - 46°	2xM5x15	5,3
370779	2	0,005	0,002	bei 45° ± 15°	90	120	113	40	210	73	40	50	150	0° - 46°	2xM5x15	11

### APPLICATION

Mainly in tool construction on grinding, milling and engraving machines, on jig boring machines, for measuring and control work and for production operations requiring high clamping precision.

### CUSTOMER BENEFITS

- ☺ The clamping device can be positively locked in any angular position

### TECHNICAL FEATURES

- Made of alloyed tool steel, hardened and very finely ground
- Bearing and support pins hardened and ground to a precision of 0.001 mm

Grinding and inspection vices

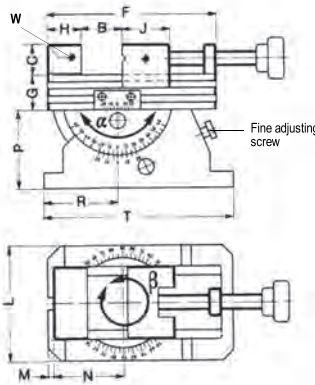

A29  
PS-ZD 2-dimensional

Item no.	Size	Squareness / 100 mm	Parallelism / 100 mm	Jaw width mm	B mm	Total height mm	C mm	Length body mm	G mm	H mm	J mm	L mm	M mm	N mm	P mm	R mm	T mm	$\beta$	$\alpha$	W	Weight kg
370782	1	0,005	0,002	70	80	137	30	160	32	33	45	110	5	65	75	70	180	360°	0° - 120°	2xM5x15	11,1
370783 ▲	2	0,005	0,002	120	150	210	40	270	50	55	70	160	10	105	120	105	270	360°	0° - 70°	2xM6x20	43

### APPLICATION

Mainly in tool construction on grinding, milling and engraving machines, on jig boring machines, for measuring and control work and for production operations requiring high clamping precision.

### CUSTOMER BENEFITS

- ☺ 2-dimensional angle adjustment via vernia, for size 1 with 3'-vernia, for size 2 with 5'-vernia
- ☺ 360° turnable

### TECHNICAL FEATURES

- Fine adjustment screw on bottom section makes exact angular adjustment possible
- Size 2 for heavy machining
- Positive locking in any desired angular position using fixing screws
- Made of alloyed tool steel, hardened and very finely ground